

型号

工作电流
引弧方式
喷嘴冷却方式
电极冷却方式
冷却水进入压力
冷却水进入温度
喷嘴孔径范围
电极直径



TK-4

0.3-50 A
高频
间接水冷
间接水冷
0.2-0.4 MPa
不高于 45℃
0.8-1.5 mm
1.2 & 2.4 mm

Model

Current Range
Art Starting
Nozzle Cooling
Electrode Cooling
Water-in Pressure
Water-in Temperature
Nozzle Aperture
Electrode Dia.

TK-4

0.3-50 A
High Frequency
Indirect
Indirect
0.2-0.4 MPa
< 45℃
0.8-1.5 mm
1.2 & 2.4 mm

等离子焊枪

■ Plasma Arc Welding Torch

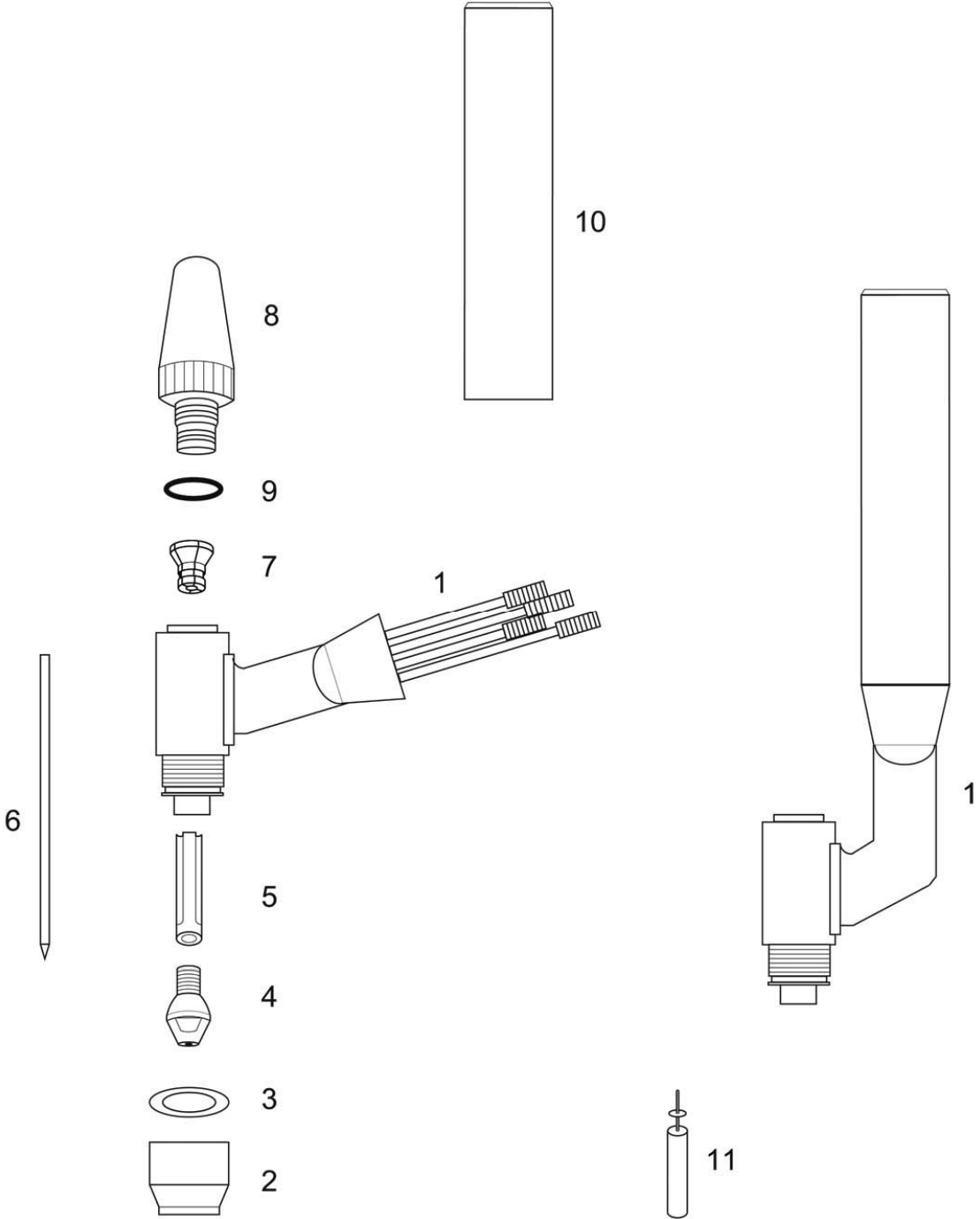

序号	订货号	产品描述	Description
1	24180	TK-4 焊枪本体 (180 度)	TK-4 Torch Body, 180 deg.
1	24181	TK-4 焊枪枪头总成 (180 度)	TK-4 Torch Head Assembly, 180 deg.
1	24182	TK-4 焊枪总成 (180 度)	TK-4 Torch Assembly, 180 deg.
1	24070	TK-4 焊枪本体 (70 度)	TK-4 Torch Body, 70 deg.
1	24071	TK-4 焊枪枪头总成 (70 度)	TK-4 Torch Head Assembly, 70 deg.
1	24072	TK-4 焊枪总成 (70 度)	TK-4 Torch Assembly, 70 deg.
2	24300	TK-4 保护罩	TK-4 Shield Cup
2	24301	TK-4 保护罩 (加网)	TK-4 Shield Cup (With nets in.)
3	24000	TK-4 保护罩胶垫	TK-4 Shield Cup Gasket
4	24206	TK-4 导电嘴 0.6mm	TK-4 Tip, 0.6mm
4	24208	TK-4 导电嘴 0.8mm	TK-4 Tip, 0.8mm
4	24210	TK-4 导电嘴 1.0mm	TK-4 Tip, 1.0mm
4	24212	TK-4 导电嘴 1.2mm	TK-4 Tip, 1.2mm
4	24215	TK-4 导电嘴 1.5mm	TK-4 Tip, 1.5mm
5	24312	TK-4 对中块 (Φ1.2)	TK-4 Insulating Sleeve (Φ1.2)
5	24324	TK-4 对中块 (Φ2.4)	TK-4 Insulating Sleeve (Φ2.4)
6	24712	TK-4 钨极 (Φ1.2)	TK-4 Electrode (Φ1.2)
6	24724	TK-4 钨极 (Φ2.4)	TK-4 Electrode (Φ2.4)
7	24612	TK-4 钨极夹 (Φ1.2)	TK-4 Collet (Φ1.2)
7	24624	TK-4 钨极夹 (Φ2.4)	TK-4 Collet (Φ2.4)
8	24909	TK-4 枪帽	TK-4 Back Cap
9	24009	TK-4 枪帽 O 形胶圈	TK-4 Back Cap O-ring
10	24800	TK-4 枪柄 (胶木材质)	TK-4 Handle (Bakelite)
10	24808	TK-4 枪柄 (不锈钢材质)	TK-4 Handle (Stainless Steel)
11	24200	TK-4 钨极限位塞规	TK-4 Electrode Setting Gauge

等离子焊枪

■ Plasma Arc Welding Torch

外形尺寸 (单位: mm)

Dimensions (Unit: mm)

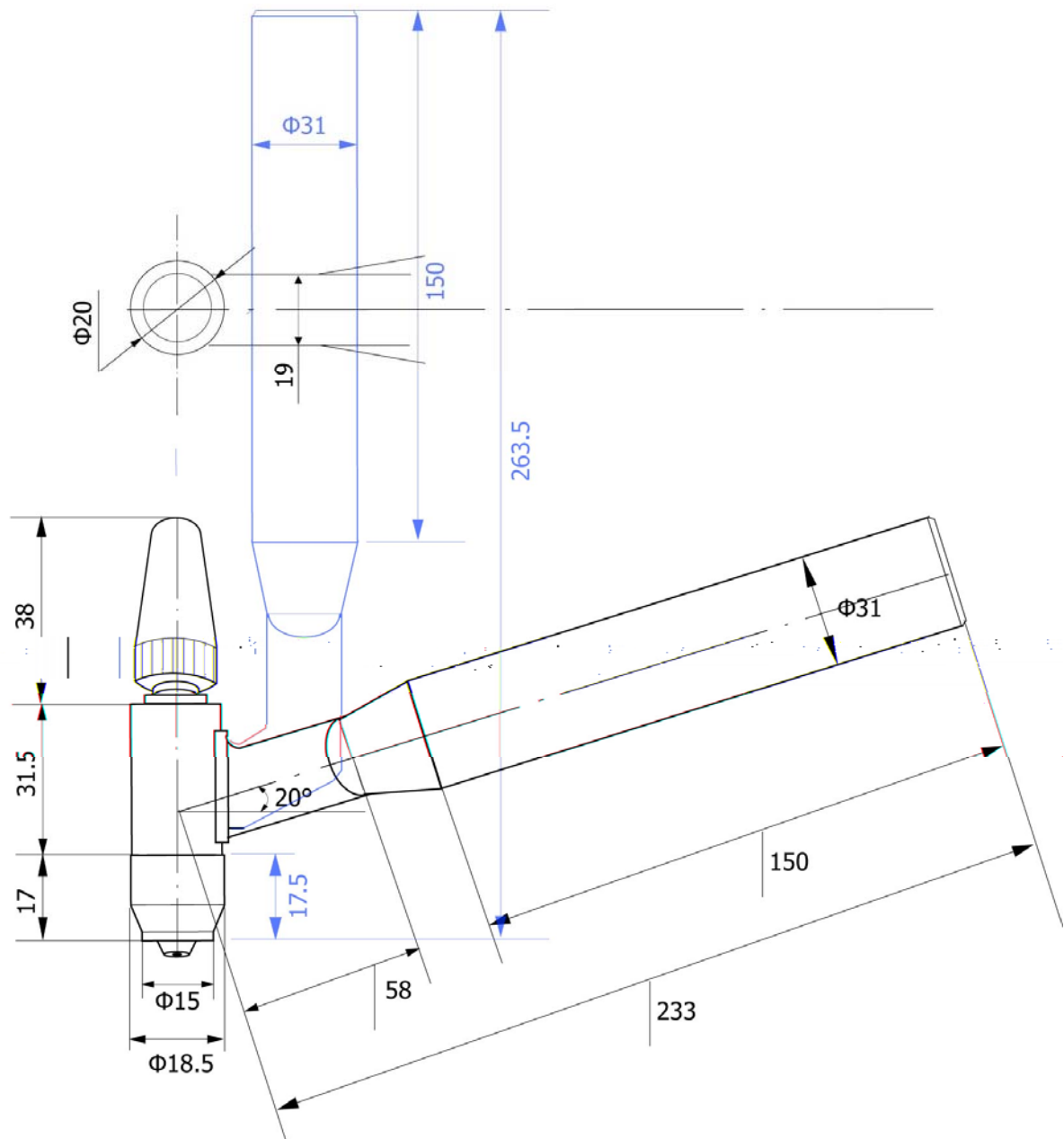

TONKS 三力易胜

TEL: 86-10-81454970 / 4970

FAX: 86-10-64421321

E-mail: support@tonksweld.com